

Swivel-Bolt 'Bolt-On' Access Control Lock Options

Product Overview (Swivel-Bolt) (Standard) Access Control Safe Lock Option

ROSS has seen a huge increase in the protection of drugs required by government legislation and the range of interface options offered to both the domestic and commercial users. The ROSS **12v Access Control Safe Lock** range enables easy interfacing to existing access control networks.

This product comes complete with a bolt monitoring switch, 12v Actuator, termination resistors and (6) pick-resistant levers keyed to a restricted and registered key profile that provides the ultimate in security within the one universal lock footprint.



1000-AC2/RP40 Access Control Safe Lock

Electronic Models

Termination resistor options include –

- **1000-AC0** is the **11.0k** and **22.0k** option.
- **1000-AC1** is the **4.7k** and **9.4k** option.
- **1000-AC2** is the **no** termination resistor option that allows you to connect to your own requirements.

Alternative Lock Option

- A 'Swivel-Bolt' Bramah (Key-Override) access control safe lock version.
- A 'Dead-Bolt' access control safe lock version.

This unit is patented and Australian Made

Product Benefits

- The ROSS 12v Access Control Safe Lock provides a huge cost saving as the lock can be fitted to any standard safe without the need of a special redundant override plate system.
- The 12v Actuator typically draws between 100 and 150 mA for about a 1/10th of a second and then about 11mA whilst the power is supplied.
- The micro-switch within the lock will detect the swivel-bolt movement into the lock-case during opening. An optional self-adhesive reed-switch can also be supplied to detect whether the safe door is closed.
- This lock is also supplied with (2) wires for power and (2) wires for the micro-switch.
- In the event where an electronic opening is not possible, the key can be sourced or used to open the unit.
- The knowledge that the lock is registered. A key(s) can be supplied at the time of purchase or supplied at a time when a key opening is necessary. This option may suit some end-users where the availability of a key creates concern.
- The lock is constructed for strength and is a quality all stainless-steel safe lock. It is also certified as withstanding (10) times the bolt-head pressure requirement of Australian Standards AS4145.2.
- The lock-case also comes complete with (2) drilled and tapped re-locker holes.

Alternative key option

- An alternative keying consideration is the 'RQK' option. Please refer to the 'RQK - Restricted Quick Key' brief for further information.
- With the knowledge these restricted profile keys are assembled, a joint agreement with a compliant service agency will allow these keys to be assembled on-site and dismantled once the key has served its purpose.

Electronic 'Bolt-On' Handing Option

Bolt-On Options

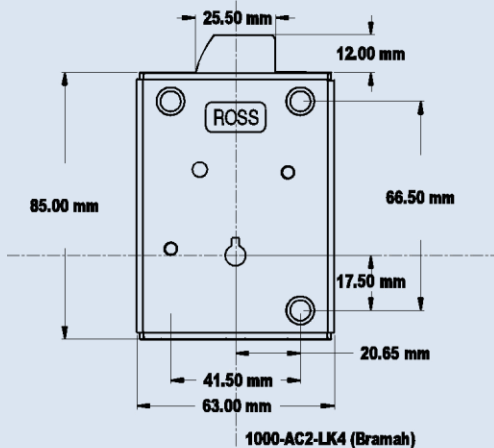
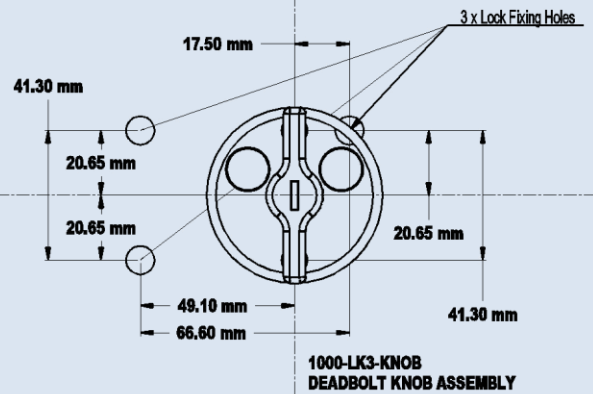
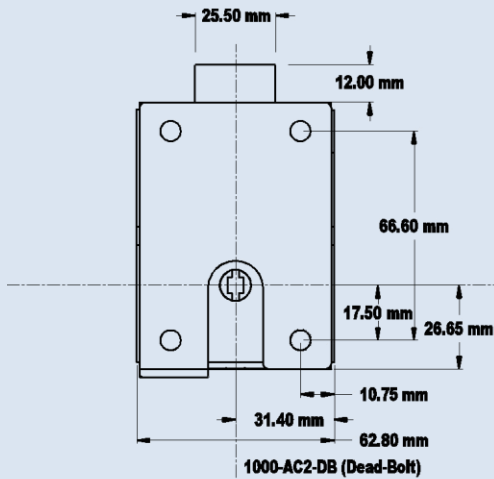
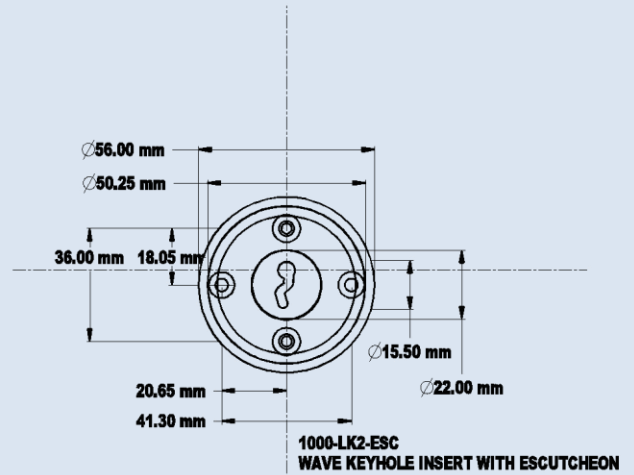
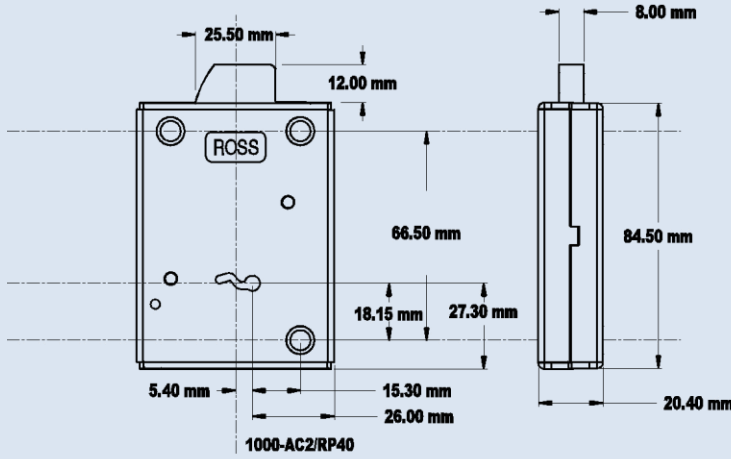

Wiring Details

Wire	Signal
Red	(+) Power
Black	(-) Power
Blue	Switch - Bolt monitoring Warning do not connect power
White	Switch - Bolt monitoring Warning do not connect power

WARNING
USE ONLY 5MM DEPTH
SCREW

1000-AC0
Bolt Switch Details
With Termination Resistors

Swing Bolt	Resistance
Out	11.0 k
In	22.0 k

1000-AC1
Bolt Switch Details
With Termination Resistors

Swing Bolt	Resistance
Out	4.7 k
In	9.4 k

1000-AC2
With No Termination Resistors

Swing Bolt	Resistance
Out	Short Circuit
In	Open Circuit