

**Electronic Lock Set Accessories**

**Multi-Lock Junction Module**

The Multi-Lock Junction Module enables you to use (1) entry-pad to operate up to (4) safe locks. The entry-pad and all locks are connected by separate cables into this junction box.

Please note –

- Safe lock cable lengths cannot exceed (3) metres.
- This junction module also has an AC input port that allows your lock(s) to be powered by AC mains power. The 9v battery is then used as backup power in the event of a power failure.



**1000-MJM (Multi-Lock Junction Module)**

**Accessories include -**

- An AC/DC Power Adaptor. This unit can be used on both the 'Junction and Duress' modules.
- An Alarm Buzzer. For those locks fitted with lock bolt status and door open status sensors, an alarm buzzer can be deployed where an alarm system interface is not possible.
- A Magnetic Door Sensor. Can be deployed to monitor the status of the safe door.

**Multi-Lock Duress Module**

The Multi-Lock Duress Module can be deployed where a Duress Interrupt, Door Open Time and/or Penalty Time needs to be monitored. This module again enables you to use (1) entry-pad to operate up to (4) safe locks and interfaces with your alarm system using a normal 'open/closed' circuit.

Please note –

- Safe lock cable lengths cannot exceed (3) metres.
- (3) output ports either connect directly into your alarm panel interface or can be connected to a standalone audible alarm buzzer.
- Output (1) reports 'Door-open-over-max-time'.
- Output (2) reports 'Penalty-time'.
- Output (3) reports 'Duress-code-entry'.
- (1) input port allows you to monitor the door status using a magnetic door switch which reports on an 'open/closed' state.
- This junction module also has an AC input port that allows your lock(s) to be powered by AC mains power. The 9v battery is then used as backup power in the event of a power failure.

**1000-MDM WIRING DIAGRAM**

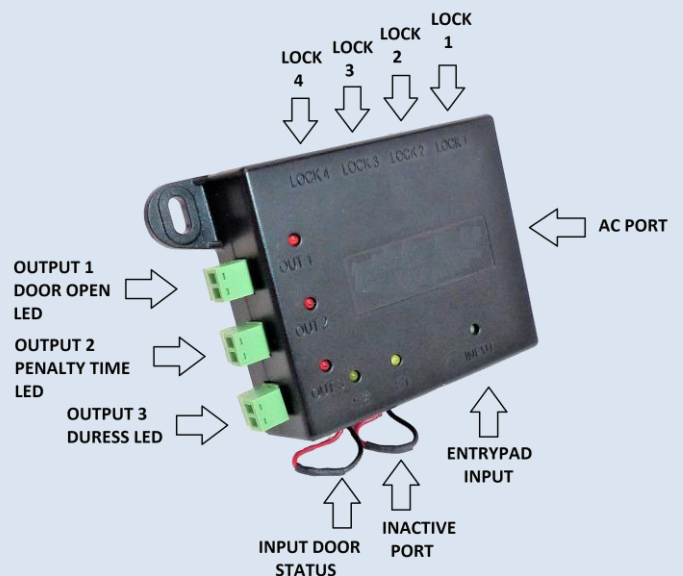

ALARM REPORTS DOOR OPEN / PENALTY TIME / DURESS

**1000-MDM (Multi-Lock Duress Module)**