

212-Series 'Bolt-On' Winged Dual Control Safe Lock Options

Product Overview

The **212-Series Winged Dual Control Safe Lock** was introduced to address the needs of the banking sector at the time. Again, based on the then new 100-Series lever and taking advantage of the 206-Series lock design, this lock consists of (2) sets of (6) levers, and was primarily fitted to banker sub-treasury cash drawer units. Today this lock is also based on the 102-Lever design.



212-W/R30 Safe Lock

- The 212-Series Safe Lock range uses the 102-Lever design. A 102-Series Key & Lever Kitt includes a brass key gauge and laminated lever chart.



'Bolt-On' Handing Options

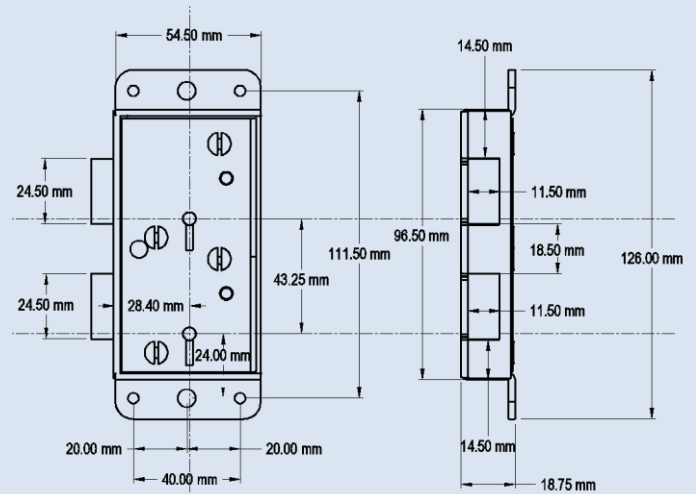

212-WL/R30

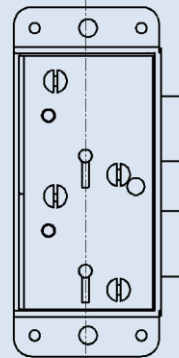

212-WR/R30

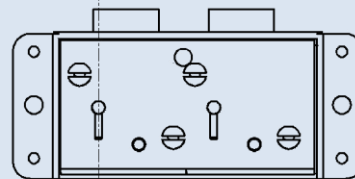

212-W/R40

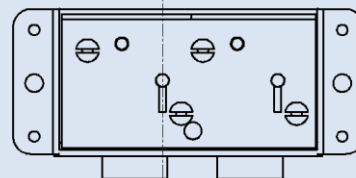

212-WD/R40