

408-Series 'Block' Safe Lock Options

Product Overview

The **408-Series 'Block' Safe Lock** was also targeted at the Grade-A Security rated units of the day. For additional security the (8) lever version with an extra two (2) 400-Series 'open-gate' pick resistant serrated lever added. The (4) corner fixing ferrule holes made the installation task a simple one.

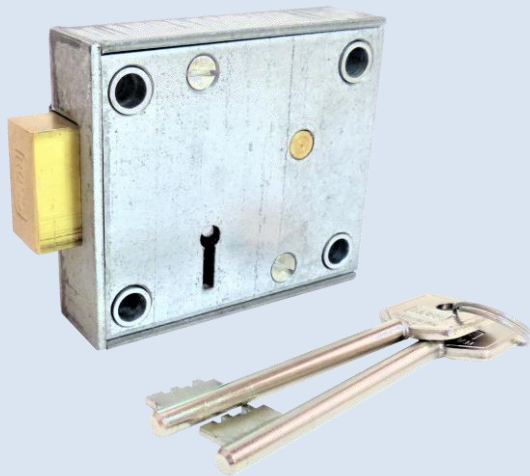

408-BFL/A50 Safe Lock

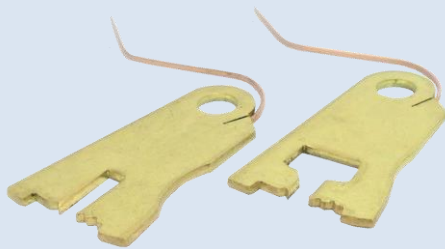

Open Gate Lever

Racked Lever

- The 408-Series 'Block' Lever Lock consists of two types of serrated levers. (6) open gated levers and the top (2) racked levers make up the lever pack in this lock. The lever spring is also kinked to produce a stronger tension due to positioning inside case. The brass 102-Series key gauge will also assist in key decoding.

8-Lever 'Bolt-On' Handing Options

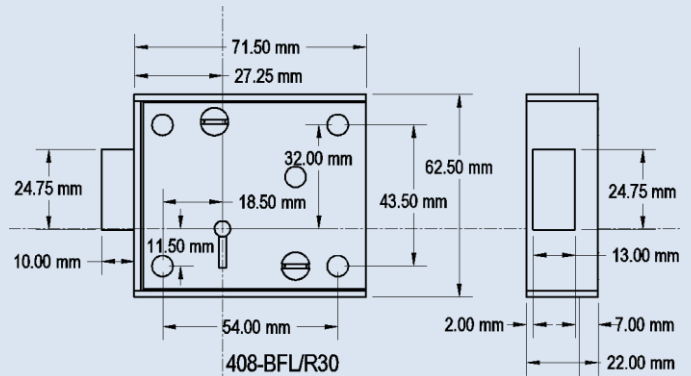

408-BFL/R30

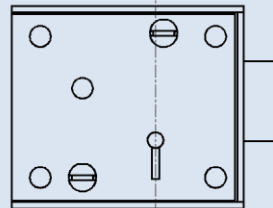

408-BFR/R30

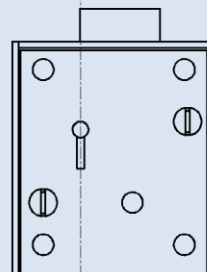

408-BF/R40

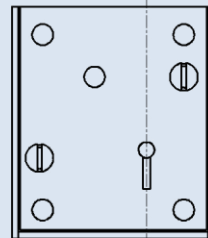

408-BFD/R40